



LOCATION

Located about 30km off the coast of Kedah and made up of a cluster of 99 islands, Langkawi Island was accorded the World Geopark title by UNESCO in 2007. It is a favourite shopping destination for both local and international visitors, thanks to its status as a duty-free port. Langkawi is accessible by ferry from Kuala Kedah, Kuala Perlis and Penang. Daily flights are also available from Penang, Kuala Lumpur and Singapore.

ACCOMMODATION

5-star • 412 rooms and suites • air-conditioning • cable TV • IDD telephone • in-room Wi-Fi access • safe deposit box • mini bar • coffee and tea facilities • hairdryer • iron and ironing board • individual balcony.

ROOM CATEGORIES

Room Category	Room Size	Room Category	Room Size
Rainforest Chalet	32m ²	Premier Chalet	56m ²
Rainforest Studio	65m ²	Premier Suite On Water	65m ²
Family Chalet	65m ²	Executive Suite	115m ²
		Presidential Suite	148m ²

RESORT FACILITIES & SERVICES

computers with internet access • courier, mail and postage services • foreign currency exchange • major credit cards accepted • Wi-Fi access in public areas • laundry service • childcare service upon request (with 24 hours' notice) • souvenir gift shop • clinic • shuttle service within resort • airport transfer • shuttle service to town and night market • car rental service • 24-hour security and CCTV surveillance

RESTAURANTS & BARS

Dayang Café: serving Malaysian & international cuisine
Oriental Pearl: serving Cantonese, Szechuan & Japanese cuisine
Beach Restaurant: serving Western & Indian cuisine
Pahn-Thai Restaurant: serving authentic Thai cuisine

Lobby Lounge: serving snacks & cocktails with live entertainment
Rimba Sports Bar: pub with music, fun games, live sports channels, cybercafe & mini library
Sunken Pool Bar: serving snacks & beverages by the poolside
Boat House Bar: serving snacks & beverages at the beachfront

MEETING FACILITIES

Matsirat Ballroom (up to 900 persons) • 8 separate meeting rooms with Wi-Fi

RECREATION

Taaras Spa (steam, sauna and outdoor Jacuzzi) • Kid's Club and playground • swimming pool • round island tour • mangrove tour • jungle trekking • marine park • sunset yacht cruise • beach volleyball • tennis • cycling • table tennis • gymnasium • archery • batik painting • fishing • sea sports such as parasailing, scuba diving, windsurfing, snorkelling, jet ski, joy boat ride, water ski, island hopping, banana boat, canoe/kayak, boat charters (subject to weather and sea conditions)

TRANSPORTATION

By Air	Duration	By Sea (subject to weather, sea conditions and fuel surcharge)	Duration
From Penang to Langkawi Island	40 minutes	From Kuala Perlis Jetty to Kuah Jetty, Langkawi Island	45 minutes
From Kuala Lumpur to Langkawi Island	1 hour	From Satun Jetty to Kuah Jetty, Langkawi Island	1 hour
From Singapore to Langkawi Island	1 hour and 15 minutes	From Kuala Kedah Jetty to Kuah Jetty, Langkawi Island	1 hour and 15 minutes
By Road	Duration	From Penang Island Jetty to Kuah Jetty, Langkawi Island	2 hours and 30 minutes
From Langkawi International Airport to resort	20 minutes	By Train	Duration
From Kuah Jetty, Langkawi Island to resort	45 minutes	From KL Sentral Train Station (KL) to Arau Train Station (Perlis)	6 hours
		From KL Sentral Train Station (KL) to Alor Setar Train Station (Kedah)	5 hours

BERJAYA LANGKAWI RESORT - MALAYSIA

managed by Berjaya Hotels & Resorts (BHR), a division of Berjaya Land Berhad (201765-A)

Karong Berkunci 200, Burau Bay, 07000 Langkawi, Kedah, Malaysia

+ 60 (4) 959 1888 + 60 (4) 959 1886 langkawi.rsvn@berjayahotel.com

www.berjayahotel.com



FLOOR PLAN MEETINGS & EVENTS

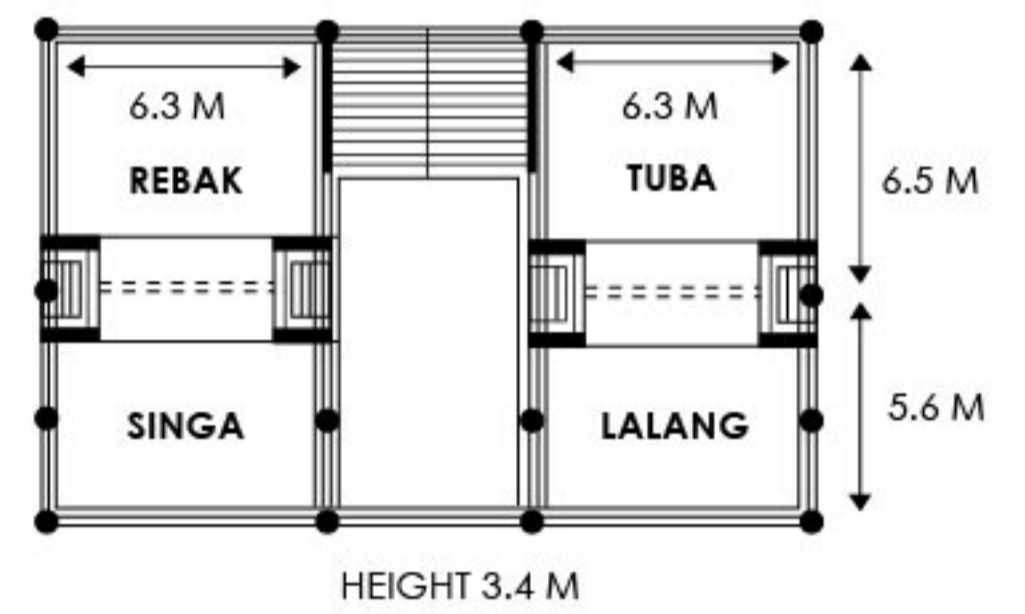
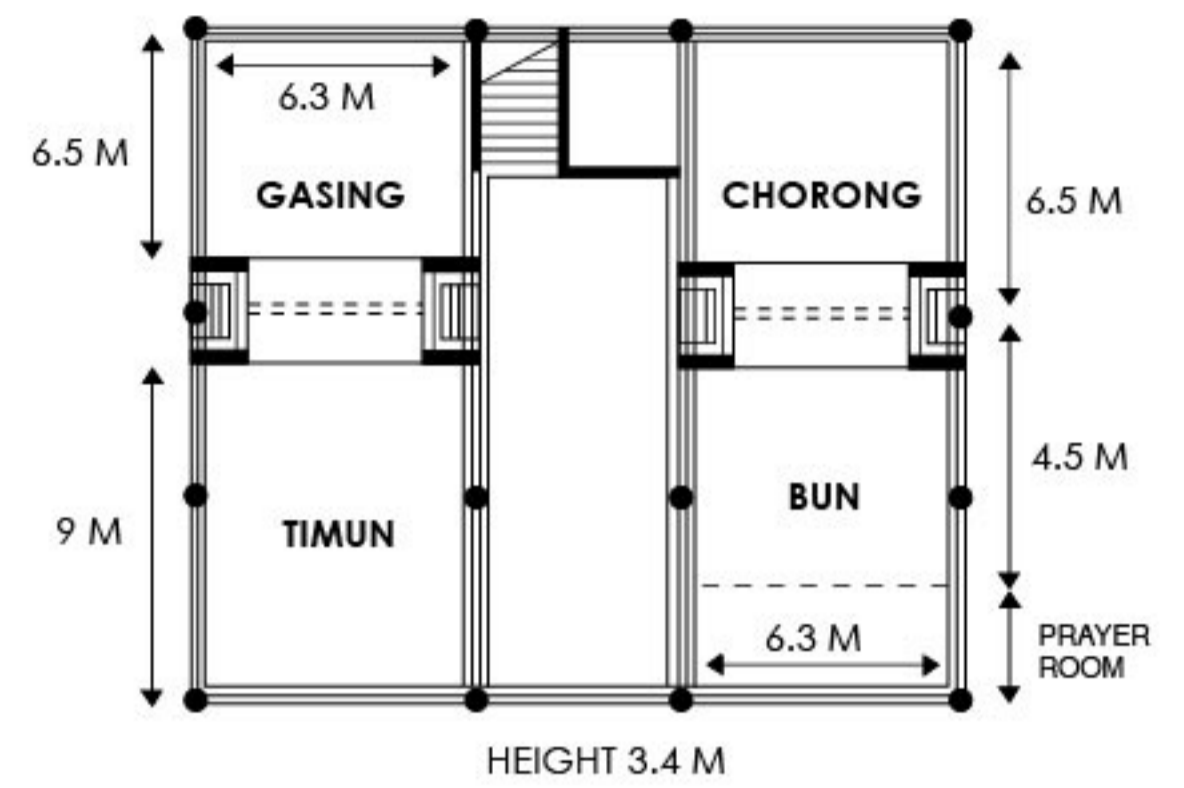
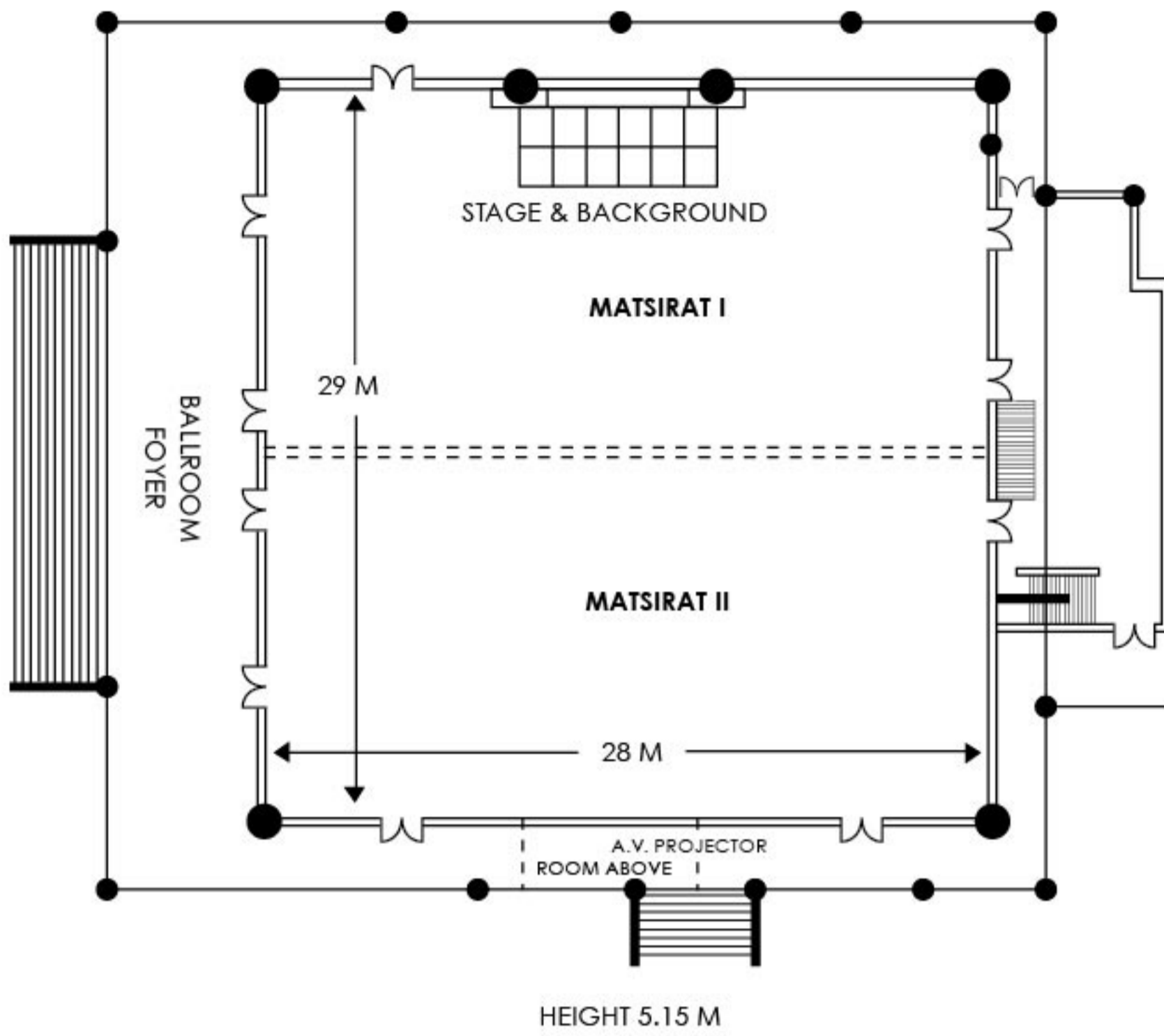

MEETINGS & EVENTS SPACE

- Matsirat Ballroom (maximum capacity : 900 persons)
- Eight (8) individual meeting rooms
- Wi-Fi internet access facilities

ROOM	LOCATION	DIMENSION (M)	SEATING CAPACITY						
			U-SHAPE	CLASSROOM	THEATRE	BANQUET	COCKTAIL	BOARDROOM	BUFFET
Matsirat Ballroom	Ground Floor	28 x 29	60	450	700	500	900	70	450
Matsirat I	Ground Floor	28 x 14.5	40	170	200	200	300	35	150
Matsirat II	Ground Floor	28 x 14.5	40	220	300	250	350	35	200
Singa	Upper Floor	6.3 x 5.6	10	12	15	10	20	12	-
Rebak	Upper Floor	6.3 x 6.5	11	12	25	12	12	20	-
Lalang	Upper Floor	6.3 x 5.6	10	12	24	12	20	12	-
Tuba	Upper Floor	6.3 x 6.5	11	12	24	12	20	12	-
Gasing	Lower Ground	6.3 x 6.5	15	24	30	10	35	16	20
Timun	Lower Ground	6.3 x 9.0	21	36	56	30	40	22	30
Chorong	Lower Ground	6.3 x 6.5	15	24	30	20	35	16	20
Bun	Lower Ground	6.3 x 4.5	-	10	20	10	30	11	-
Singa/Rebak	Upper Floor	6.3 x 12.1	21	36	56	24	40	22	20
Lalang/Tuba	Upper Floor	6.3 x 12.1	21	24	10	20	40	22	20
Gasing/Timun	Lower Ground	6.3 x 15.5	32	48	80	40	75	32	40
Chorong/Bun	Lower Ground	6.3 x 11	15	24	30	10	35	16	20